

Kanazawa Port Cruise Terminal



Visitor Information

Admission Information

- Hours/Kanazawa Port Cruise Terminal 9:00 to 21:00
(Kanazawa Port Learning and Experience Room 9:00 to 17:00)
- Closed/Dec. 29 to Jan. 3
- Admission/Free
- Restaurant Hours/10:00 to 21:00 (last order at 20:00)
(Closed on Mondays)

Parking

- Visitor Parking**
- Hours/4:00 to 22:00
 - 127spaces
 - 210spaces
 - Price/Free
- Passenger Parking**
- Hours/Based on cruise departure/arrival times
 - 145spaces
 - 128spaces
 - 80 tour bus spaces and 20 taxi spaces
 - Price/Free



The roof features a design evocative of the white foam-capped waves on the Sea of Japan.



Information

Access

- From JR Kanazawa Station: 5 km (15 min. drive)
- From the Hokuriku Expressway: 15 min. from Kanazawa-nishi IC
15 min. from Kanazawa-higashi IC

- From Kenrokuen Garden: 8 km (25 min. drive)
- From Omicho Market: 6 km (20 min. drive)
- From the Higashi Chaya Distric: 8 km (25 min. drive)
- From the 21st Century Museum of Contemporary Art: 8 km (25 min. drive)



1 Karakuri Memorial Museum

Focuses on the achievements of Ohno Benkichiro — a technologist and maker of mechanized puppets who lived in Ohno-machi, Kanazawa in the mid 19th century — as well as the world of mechanized puppets.
Ko-2-29 4-Chome, Ohno-machi, Kanazawa City
TEL: 076-266-1311
5 min.

2 Kanazawa Port Iki-Iki Fish Market

Sells fresh seafood brought in from the ports near Kanazawa. Seasonal seafood is available for sale here, with a focus on choice local seafood.
Wo-52 Muryoji-machi, Kanazawa City
TEL: 076-266-1353
5 min.

3 Zeniya Gohei Memorial Museum

Dedicated to Zeniya Gohei, a wealthy maritime merchant with the Kitamaebune ships in the early to mid 19th century. Learn about Zeniya Gohei's incredible life through the museum's theater, a 1/4-scale Kitamaebune ship, and more.
Ro-55 Kanaïwa Hon-machi, Kanazawa City
TEL: 076-267-7744
5 min.

Timetable for Buses to/from Kanazawa Port Cruise Terminal

Accurate as of April 1, 2020 (Operated by Hokutetsu Bus)

※: Sat. only △: Sun. and holidays only

	Kanazawa Port Cruise Terminal	Muryoji Bay Park	Kanazawa Sta. (W. Gate)	Korinbo (4th H.S. Museum)	Last Stop
Weekdays	7:23	7:29	7:55		Kanazawa Sta. (W. Gate)
	10:02	10:08	10:31	10:43	Okuwahoncho 11:10
	13:30	13:36	14:02		Kanazawa Sta. (W. Gate)
	14:18	14:24	14:47	14:59	Okuwahoncho 15:26
	15:40	15:46	16:12		Kanazawa Sta. (W. Gate)
	16:16	16:22	16:45	16:57	Okuwahoncho 17:24
	17:38	17:44	18:07	18:19	Okuwahoncho 18:45
	18:40	18:46	19:09	19:21	Okuwahoncho 19:47
Weekends & Holidays	10:05	10:11	10:34	10:46	Okuwahoncho 11:15
	11:00	11:06	11:27		Kanazawa Sta. (W. Gate)
	13:00	13:06	13:27		Kanazawa Sta. (W. Gate)
	15:00	15:06	15:27		Kanazawa Sta. (W. Gate)
	17:35	17:41	18:02		Kanazawa Sta. (W. Gate)

	First Bus	Korinbo (La Moda)	Kanazawa Sta. (W. Gate)	Muryoji Bay Park	Kanazawa Port Cruise Terminal
Weekdays	Okuwahoncho 7:17	7:37	7:51	8:09	8:29
	Okuwahoncho 8:30	8:50	9:04	9:22	9:42
	Kanazawa Sta. (W. Gate)		10:43	11:01	11:15
	Kanazawa Sta. (W. Gate)		12:45	13:03	13:17
	Kanazawa Sta. (W. Gate)		13:35	13:53	14:07
	Kanazawa Sta. (W. Gate)		15:30	15:48	16:02
	Kanazawa Sta. (W. Gate)		16:55	17:13	17:27
	Okuwahoncho 17:38	17:58	18:12	18:30	18:50
Weekends & Holidays	Okuwahoncho 7:30	7:48	8:00	8:18	8:31
	Okuwahoncho ※9:41	※10:01	※10:14	※10:32	※10:46
	Kanazawa Sta. (W. Gate)		△10:18	△10:32	△10:46
	Okuwahoncho 11:29	11:49	12:02	12:20	12:34
	Kanazawa Sta. (W. Gate)		14:00	14:14	14:28
	Kanazawa Sta. (W. Gate)		16:10	16:24	16:38

Note: Only major stops along the route are shown.

Kanazawa Port Cruise Terminal

Facility Information

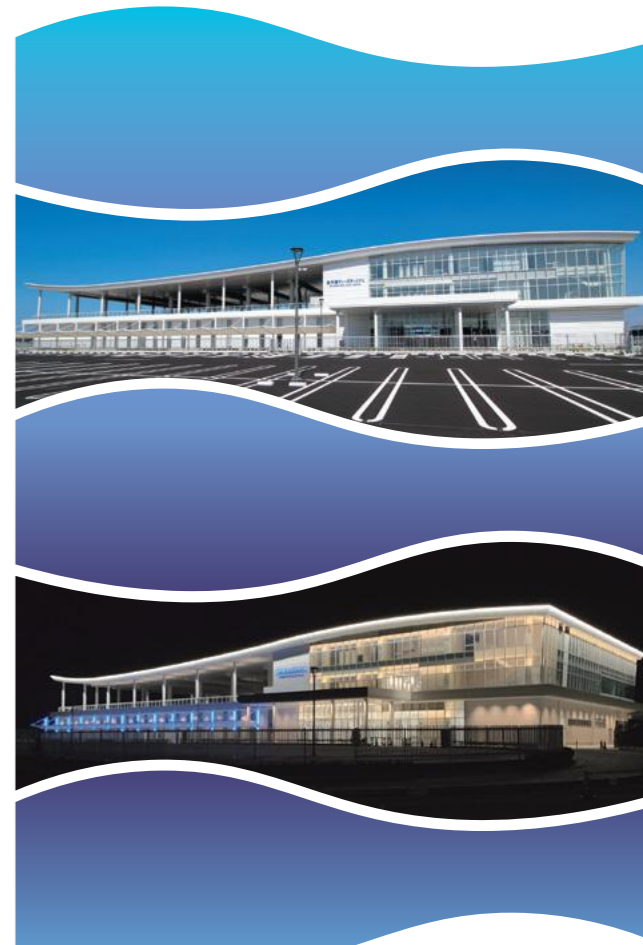

Map and Access Information

Contact

Kanazawa Port Cruise Terminal
 Ri-65 Muryoji-machi, Kanazawa City, Ishikawa
 920-0332
 TEL.076-225-7030 FAX.076-225-7082
 Mail:office@kanazawa-cruise.jp
<http://www.kanazawa-cruise.jp/>

A Whole New Way to Enjoy Kanazawa

A Home Base for Cruises and Creating Liveliness

The Kanazawa Port Cruise Terminal serves as a gateway connecting Kanazawa Port with the sea.

The CIQ and waiting areas are large enough to handle customs, immigration, and quarantine for two cruise ships simultaneously.

The floor-to-ceiling windows offer a stunning view of the Sea of Japan, as well as the lights outside at night.

The Terminal also features the Learning and Experience Room — where simulations let visitors experience what it's like to be at the helm of a cruise ship — as well as a restaurant.

In the cruise ship off-season, the CIQ and waiting areas are transformed into spaces that can be used for events, or where children can play.



View of the Sea from the Cruise Terminal

1F

With the CIQ and Waiting Areas, This Floor Serves as a Gateway between Land and Sea

- 1 CIQ Area
- 2 Waiting Area
- 3 Vending Machines
- 4 Administrative Office
- 5 Tourist Information

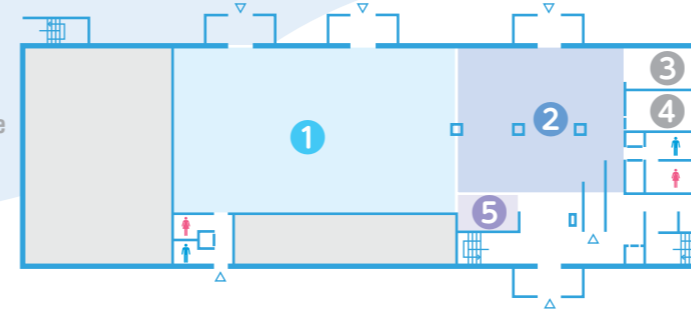

1 CIQ Area



Large enough to handle CIQ processing for 4,000 cruise passengers within two hours.

Example Use

This space can also be used for kids' sports events, or other events like business exhibitions.



2 Waiting Area



This area features two pillars decorated with eight spectacular works by leading artisans of iconic Ishikawa crafts such as Kutani Ware, Kaga Yuzen Dyed Silk, and lacquerware from Wajima, Yamanaka, and Kanazawa (made by artisans who are holders of important intangible cultural properties, or "living national treasures," and members of the Japan Art Academy), as well as sixteen smaller Ushikubi Pongee Silk and Kaga Embroidery works, against a backdrop of Kanazawa gold leaf. These pillars stand 1.3 m wide and 4.2 m tall, and display works based on the theme of the sea.

Example Use

This area can be used as a large play space for small children.



Other Features

Currency exchange machine, vending machines, postbox, and Wi-Fi available.

5 Tourist Information



Visitors can find out about nearby destinations and how to get there, as well as events going on.

2F

A Versatile Floor Where Visitors Can Have Educational Experiences, Enjoy the View, or Get a Bite to Eat

- 1 Observation Deck
- 2 Restaurant Bay Arce
- 3 Seminar Room
- 4 Kanazawa Port Learning and Experience Room
- 5 Meeting Room 1
- 6 Meeting Room 2

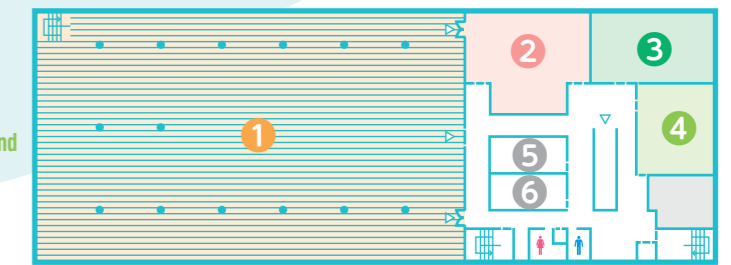

1 Observation Deck

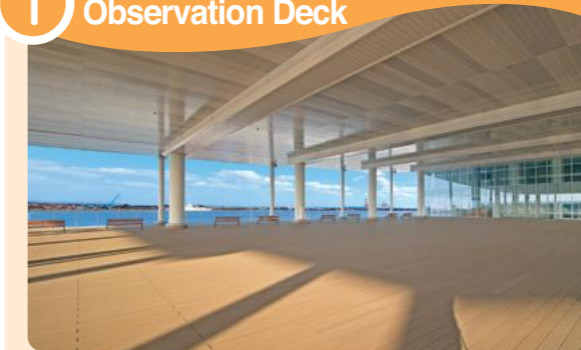

Watch the cruise ships come and go, or see someone off. Can also be used as an event venue.

2 Restaurant Bay Arce



The seating is split into three levels, to ensure a view of the sea from every seat.

3 Seminar Room



This room can serve as a rest area, or as a venue for events like business exhibitions.

Example Use

Features a large projection screen, and can accommodate up to 120.



4 Kanazawa Port Learning and Experience Room



A fun place for both kids and adults to learn about Kanazawa Port.

Kanazawa Port Ship Steering Simulator



Experience piloting a ship around Kanazawa Port for yourself! You can even choose the time of day (daytime, evening, or night) and the weather (sunny, rainy, or stormy).

¥100/Session

3F



- 1 Kanazawa Port Office
- 2 Kanazawa Port Promotion Association
- 3 Reception Room
- 4 Kanazawa Koun
- 5 Meeting Room
- 6 Kanazawa Port Service
- 7 Fisheries Patrol Vessel TEDORI Office

